



لإنتاج البلوك و الإنترلوك و البردورات و البلاط

مصنع
سليمان عبدالرحمن النملة



لإنتاج
البلوك

والإنترلوك
والبردورات
والبلاط



www.sanco-group.com



يداً بيد
لبناء الوطن بأعلى جودة



Hand in Hand
To Build Our Country With High Quality



من نحن؟

مصنع سليمان عبد الرحمن النملة متخصص في إنتاج المنتجات الاسمنتية التالية :

- البلوك الاسمنتي بمقاسات مختلفة.
- الإنترلوك بمختلف الانواع والألوان.
- الكريستون (بردورة) بمختلف المقاسات.

ويعتمد المصنع في انتاجه على مواد أولية ممتازة من السوق المحلية والمستوردة ، حيث تتم عملية خلط المواد طبقاً لمقاييس السوق العالمية وبأفضل النسب ، وتتم عملية التجفيف بالبخار في غرف مهيئة لإستقبال كميات ضخمة من المنتجات ، وتم تجهيز المصنع بمختبر يحتوي على مكائن وأجهزة خاصة لمتابعة جودة المنتج في مختلف مراحل الإنتاج ابتداءً من مرحلة استلام المواد الأولية الى مرحلة تجهيز المنتج للعمليات مع ارتباط المختبر بقسم الرقابة والجودة ، يتم كل فترة توثيق نتائج الإختبارات بشهادات من ختبرات محلية معتمدة في السوق السعودية. وبسب الخبرة الطويلة التي تمتلكها مجموعة شركات النملة في هذا المجال والتي تمتد لأكثر من أربعون عام والرغبة في خدمة الاقتصاد الوطني برزت فكرة انشاء هذا المصنع. نسأل الله العلي القدير ان يبارك في هذا المشروع ويجعل فيه الخير للجميع والله الموفق.

مصنع سليمان عبد الرحمن النملة هي شركة سعودية ذات مسؤولية محدودة برأس مال سعودي ١٠٠ ٪ نشأت فكرة المصنع بناءً على الطلب المتنامي على المنتجات الإسمنتية والذي نشأ عن الحركة العمرانية والطفرة في مجال الانشآت والنمو الملحوظ لهذا القطاع في ظل قيادة خادم الحرمين الشريفين وخصوصا في المنطقة الغربية .

تأسس مصنع سليمان عبد الرحمن النملة عام ٢٠١٣ وهو من المصانع الرائدة في المملكة العربية السعودية وذلك بفضل استخدامه لأحدث المكائن والتقنيات الألمانية التي توفر له طاقة إنتاجية عالية من حيث الجودة والكمية ، وتمثل الطاقة الإنتاجية له ما يعادل ١٠٠,٠٠٠ حبة من البلوك يوميًا ، ٤,٠٠٠ م٢ من الإنترلوك ١٢,٠٠٠ م طولي من الكريستون (بردورة) بشكل يومي.

ويقع المصنع في مدينة ينبع في المنطقة الصناعية للهيئة الملكية والتي تتبع في استثماراتها أعلى المقاييس ومعايير الجودة العالمية وتتمثل هذه المعايير في استخدام أحدث المكائن لإنتاج منتجات مطابقة لأعلى معايير الجودة و بأمثل طرق التغليف حتى تسهل للمستهلك نقلها واستخدامها بأحدث معايير السلامة.



who are we ?

Suleiman A. R. Al Namlah factory is a limited liability company with a 100% of Saudi capital. The idea of the establishment of the factory based on the growing demand for cement products which grew for Urban movement and the boom in the field of construction and the remarkable growth of this sector under the leadership of the custodian of the Two Holy Mosques, especially in the western region.

The factory was founded in 2013 as one of the leading factories in Saudi Arabia and that for their use of the latest machines and German technology, which provides a high-energy production in terms of quality and quantity, and its production capacity represents the equivalent of 100,000 blocks, 4,000m² of interlock 12,000m linear meters of Curbstone on a daily basis. The factory is located in Yanbu City in the industrial zone of the Royal Commission, which follows in its investments the highest standards and international quality standards and these standards are demonstrated by the usage of the latest machinery to produce products that conform to the highest quality standards and the best packaging methods to make it easier for the consumer to transport and use them.

Our factory specializes in the production of the following cement products:

- Concrete blocks in different sizes.
- Interlocks in various types and colors.
- Curbstone in various measurements.

The factory relies in its production on excellent raw materials from the local and imported market, where the process of mixing materials according to the standards of the world market and at the best proportions, and the process of steam drying is carried out in rooms prepared to receive large quantities of products, and the factory is equipped with a laboratory containing special machines and equipment to follow the quality of the product at various stages of production, starting from the stage of receipt of raw materials to the stage of processing the product to the client with the link of the laboratory to the department of control and quality. Each period of documentation of the test results is carried out with certificates from local laboratories accredited in the Saudi market. Because of the long experience of Al Namlah companies in this field, which extends for more than 40 years and the desire to serve the national economy, the idea of establishing this plant has emerged. We ask Allah Almighty to bless this project and make it good for all.

مشاريع سا نكو



SANCO PROJECTS



منتجاتنا

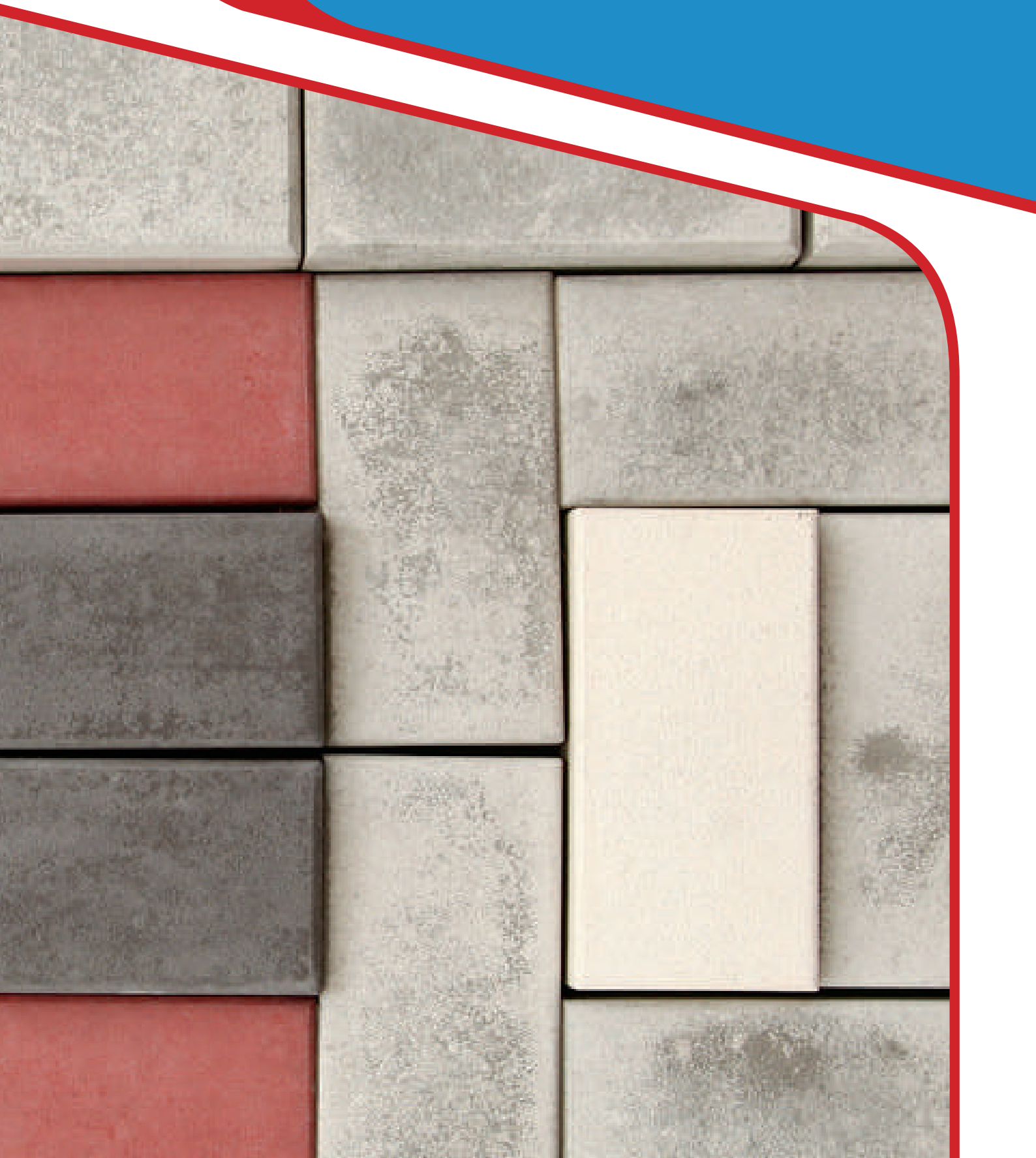

Our Products



Interlock Holland

Technical details

Type	Holland		
Thickness	6	8	10
Area per Stone (Cm ²)	200	200	200
Stones per (m ²)	50	50	50
Weight (Kg)	2.7	3.8	4.73

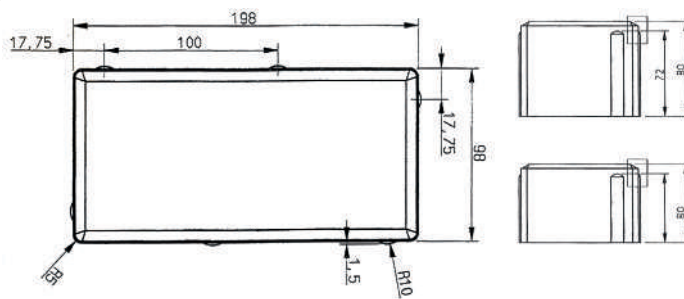
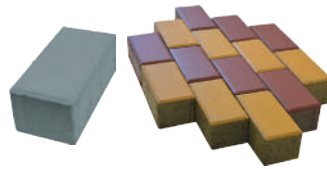

Product catalogue

Colours available



This is offset printout, colours may differ from the original stones, please see the original sample stone for colour variation.

Interlock Square

Technical details

Type	Square 20x20	
Thickness	6	8
Area per Stone (cm ²)	400	400
Stones per (m ²)	25	25
Weight	5.5	7.6

Type	Square 10x10	
Thickness	6	8
Area per Stone (cm ²)	100	100
Stones per (m ²)	100	100
Weight	1.35	-

Type	Square 8x8
Thickness	6
Area per Stone (cm ²)	64
Stones per (m ²)	156.25
Weight (kg)	0.9

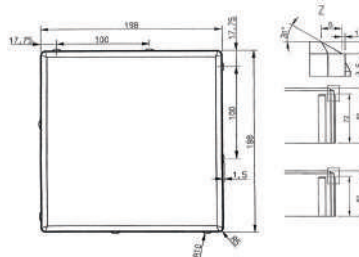

Product catalogue

Colours available



This is offset printout, colours may differ from the original stones, please see the original sample stone for colour variation.

Interlock Behaton

Technical details

Type	Behaton	
Thickness	6	8
Area per Stone (cm ²)	280	280
Stones per (m ²)	35.72	35.72
Weight (kg)	3.8	4.8

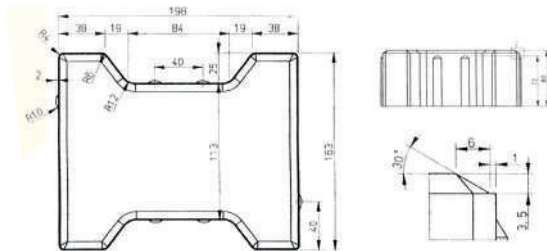
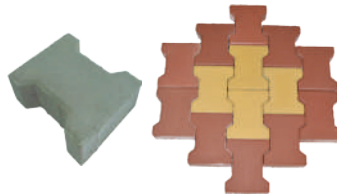

Product catalogue

Colours available



This is offset printout, colours may differ from the original stones, please see the original sample stone for colour variation.

Interlock Hexagonal

Technical details

Type	Hexagonal	
Thickness	6	8
Area per Stone (cm ²)	337	337
Stones per (m ²)	29.67	29.67
Weight (kg)	4.7	6.8

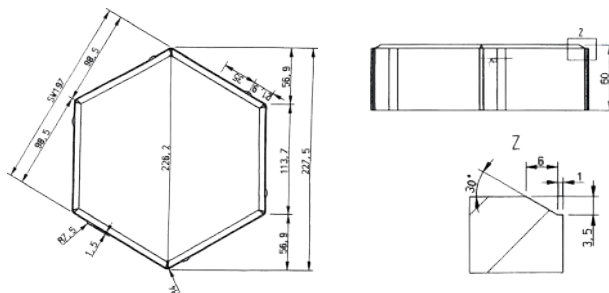

Product catalogue

Colours available



This is offset printout, colours may differ from the original stones, please see the original sample stone for colour variation.

Interlock Uni

Technical details

Type	Uni
Thicknes	6
Area per Stone (cm2)	256
Stones per (m2)	39.5
Weight (kg)	3.5

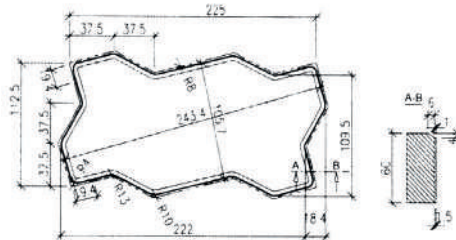
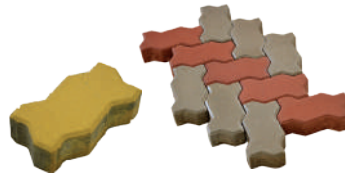

Product catalogue

Colours available

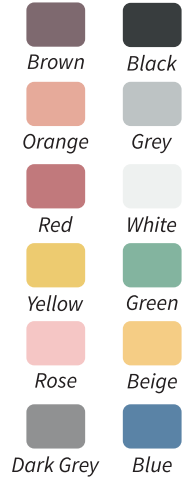

This is offer printout, colours may differ from the original stones, please see the original sample stone for colour variation.

Interlock Delta

Technical details

Type	Delta
Thicknes	6
Area per Stone (cm2)	208
Stones per (m2)	48
Weight (kg)	2.8

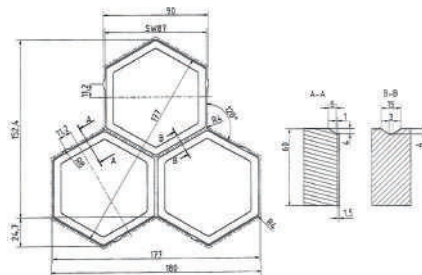

Product catalogue

Colours available



This is offer printout, colours may differ from the original stones, please see the original sample stone for colour variation.

Interlock 3D

Technical details

Type	3D
Thicknes	6
Area per Stone (cm2)	256
Stones per (m2)	39.5
Weight (kg)	3.5

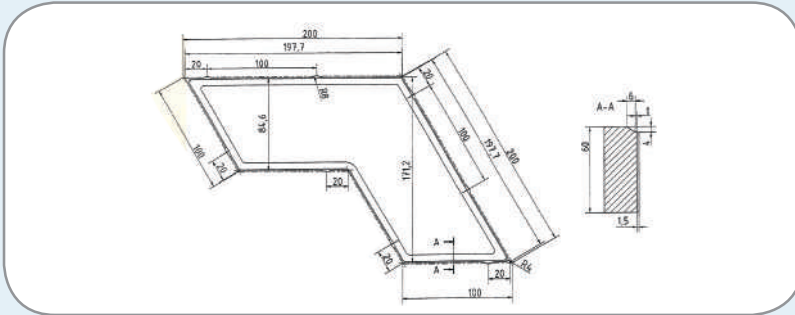

Product catalogue

Colours available



This is offset printout, colours may differ from the original stones, please see the original sample stone for colour variation.

Interlock Octa & Cube

Technical details

Type	Octa	Octa	Cube
Thickness	6	8	6
Area per Stone (Cm ²)	336	336	64
Stones per (m ²)	29.76	29.76	156.25
Weight (Kg)	4.5	6.6	0.9

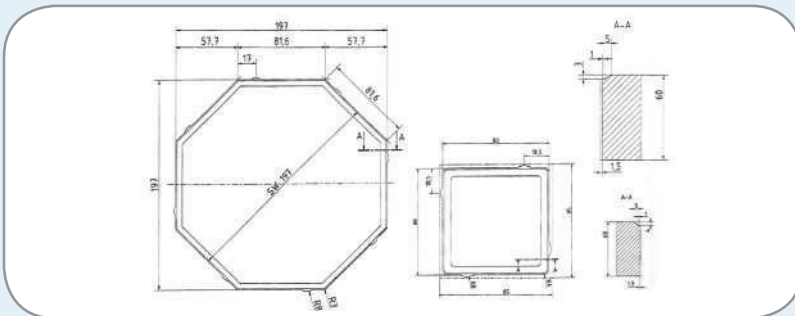
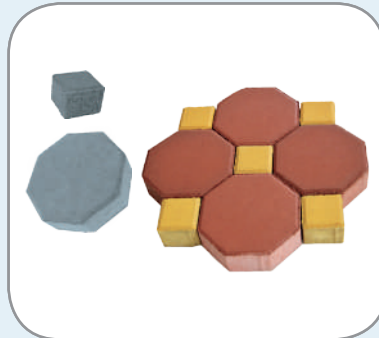

Product catalogue

Colours available



This is offset printout, colours may differ from the original stones, please see the original sample stone for colour variation.

Interlock Laplaza

Technical details

Type	Laplaza
Thicknes	6
Area per Stone (cm2)	483
Stones per (m2)	20.65
Weight (kg)	6.7



Product catalogue

Colours available



This is offer printout, colours may differ from the original stones, please see the original sample stone for colour variation.

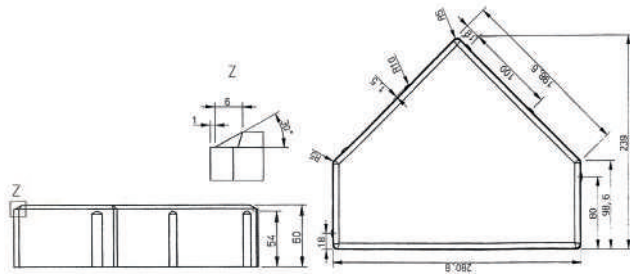

Interlock Quadro

Technical details

Type	Quadro
Thicknes	6
Area per Stone (cm2)	191.01
Stones per (m2)	52.4
Weight (kg)	2.75

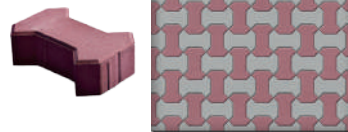

Product catalogue

Colours available



This is offer printout, colours may differ from the original stones, please see the original sample stone for colour variation.

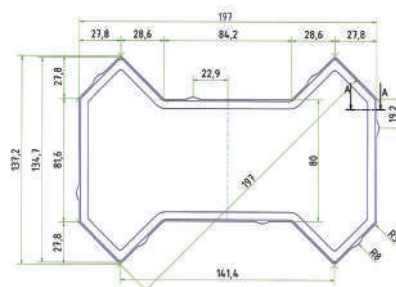

Cement Tiles (40X40 Cm)

Technical details

Type	Cement Tiles (40X40)	
Thickness	4	5
Area per Stone (Cm ²)	1585.46	1585.46
Stones per (m ²)	6.25	6.25
Weight (Kg)	15.2	18.5

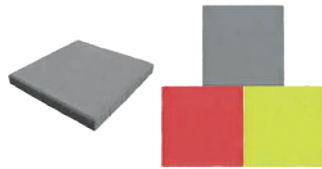

Product catalogue

Colours available



This is offset printout, colours may differ from the original stones, please see the original sample stone for colour variation.

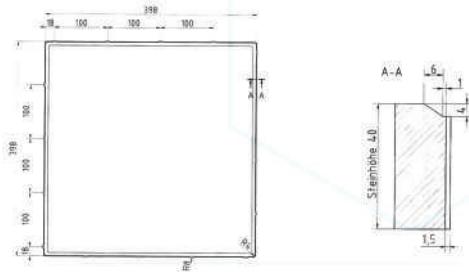

Cable Tiles

Technical details

Type	Cable Tiles (20X40)		
Thickness	5	6.5	8
Area per Stone (Cm ²)	800	800	800
Stones per (m ²)	12.5	12.5	12.5
Weight (Kg)	8.5	11.4	13.8

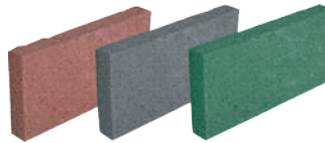

Product catalogue

Colours available



This is offset printout, colours may differ from the original stones, please see the original sample stone for colour variation.

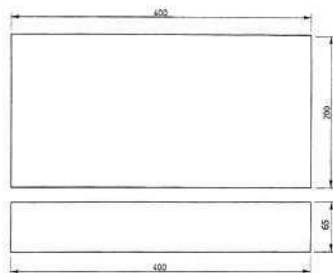

Kerbstone Municipality

Technical details

Type	Kerbstone Municipality
Size (Cm)	50X30X15
Stones Per LM	2
Weight (Kg)	50.2

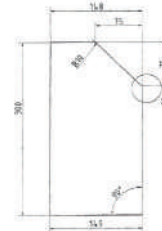
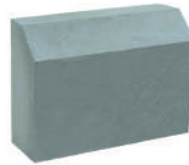

Product catalogue

Colours available

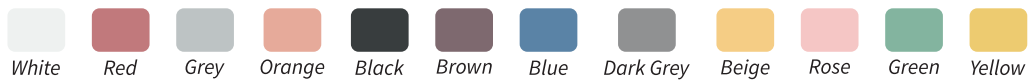

This is offset printout, colours may differ from the original stones, please see the original sample stone for colour variation.

Kerbstone Half

Technical details

Type	Kerbstone Half
Size (Cm)	25X30X15
Stones Per LM	4
Weight (Kg)	23.9

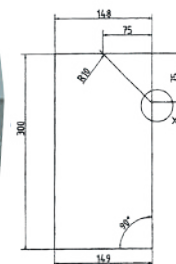
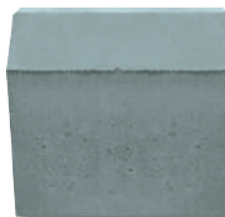

Product catalogue

Colours available



This is offset printout, colours may differ from the original stones, please see the original sample stone for colour variation.

Kerbstone M.Corner Internal & External

Technical details

Type	Kerbstone M.Corner Internal & External
Size (Cm)	25X25X30X15
Weight (Kg)	34

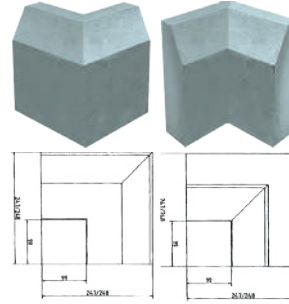

Product catalogue

Colours available

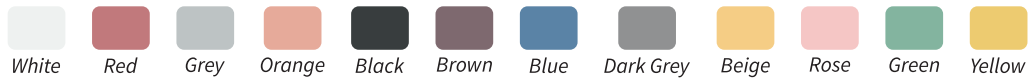

This is offset printout, colours may differ from the original stones, please see the original sample stone for colour variation.

Kerbstone (50X20X15 Cm)

Technical details

Type	Kerbstone 50X20X15
Size (Cm)	50X20X15
Stones Per LM	2
Weight (Kg)	32.4



Product catalogue

Colours available

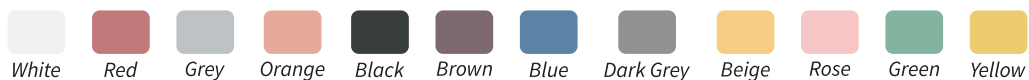

This is offset printout, colours may differ from the original stones, please see the original sample stone for colour variation.

Kerbstone (50X40X15 CM)

Technical details

Type	Kerbstone Municipality
Size (Cm)	50X40X15
Stones Per LM	2
Weight (Kg)	65.2

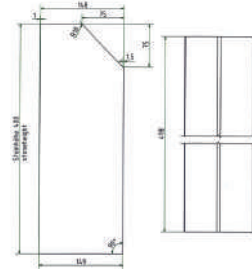

Product catalogue

Colours available

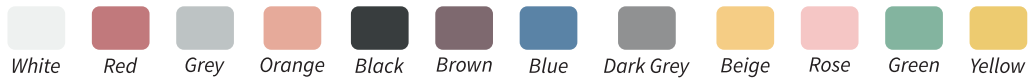

This is offset printout, colours may differ from the original stones, please see the original sample stone for colour variation.

Kerbstone Flower

Technical details

Type	Kerbstone Flower
Size (Cm)	50X30X10
Stones Per LM	2
Weight (Kg)	33

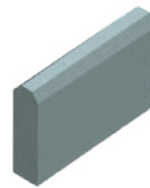

Product catalogue

Colours available

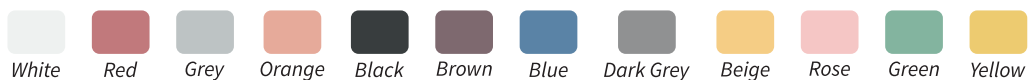

This is offset printout, colours may differ from the original stones, please see the original sample stone for colour variation.

Kerbstone Flower Corner

Technical details

Type	Kerbstone Flower Corner
Size (Cm)	50X30X10
Weight (Kg)	26.7

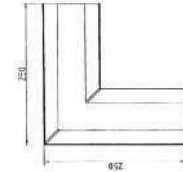
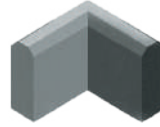

Product catalogue

Colours available

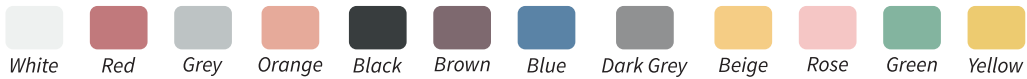

This is offset printout, colours may differ from the original stones, please see the original sample stone for colour variation.

Kerbstone Flower 25 Cm

Technical details

Type	Kerbstone Flower 25 Cm
Size (Cm)	25X30X10
Stones Per LM	4
Weight (Kg)	16.5



Product catalogue

Colours available

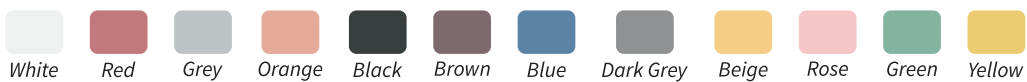

This is offset printout, colours may differ from the original stones, please see the original sample stone for colour variation.

Kerbstone M 91.5

Technical details

Type	Kerbstone M 91.5
Size (Cm)	91.5X30X15
Stones Per LM	1
Weight (Kg)	92

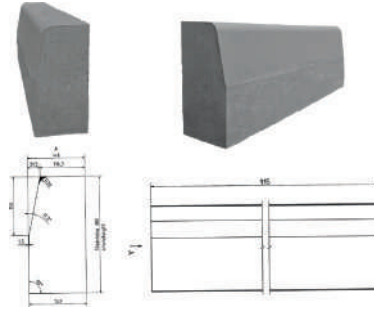

Product catalogue

Colours available

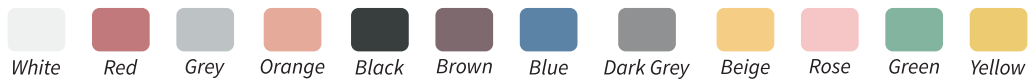

This is offset printout, colours may differ from the original stones, please see the original sample stone for colour variation.

Kerbstone (Flush)

Technical details

Type	Kerbstone Flush	
Size (Cm)	50X30X15	40X20X10
Stones Per LM	2	2.5
Weight (Kg)	52	19.5

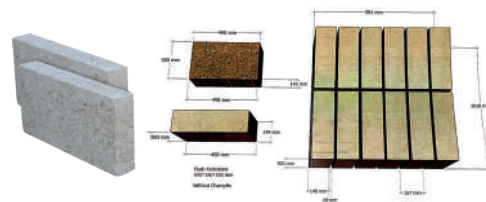

Product catalogue

Colours available

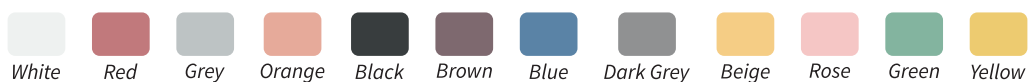

This is offset printout, colours may differ from the original stones, please see the original sample stone for colour variation.

Block (Open Bottom) 10 Cm

Technical details

Type	10 Cm Open From Bottom				
No. of holes	2				
Size (Cm)	10X20X40				
Materials	nlb	lb	ff	mk	lb
Thickness	3	3	3	4	4
Weight (Kg)	12.2	12.35	10.85	13.65	14

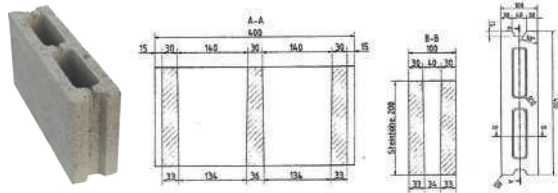

Product catalogue

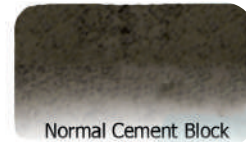

This is offset printout, colours may differ from the original stones, please see the original sample stone for colour variation.

Block (Close Bottom) 10 Cm

Technical details

Type	10 Cm Closed From Bottom	
No. of holes	3	
Size (Cm)	10X20X40	
Thickness	3	
Weight (Kg)	13.85	
Materials	nlb	nlb (volcanic)
Thickness	3	3
Weight (Kg)	13.85	9.7

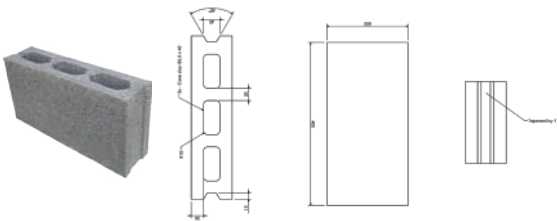

Product catalogue

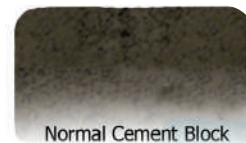
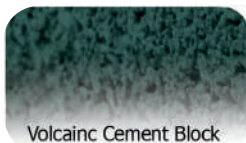

This is offset printout, colours may differ from the original stones, please see the original sample stone for colour variation.

Block (Solid) 10 Cm

Technical details

Type	10 Cm Solid Block
No. of holes	0
Size (Cm)	10X20X40
Thickness	-
Weight (Kg)	16.35

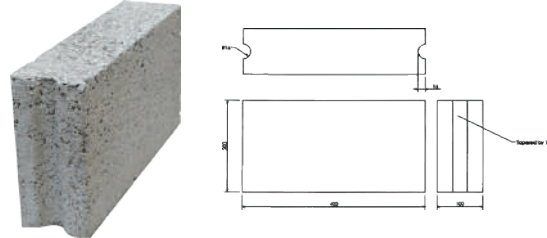

Product catalogue

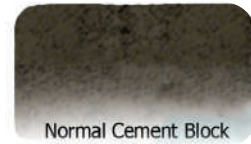

This is offset printout, colours may differ from the original stones, please see the original sample stone for colour variation.

Block (Open Bottom) 15 Cm

Technical details

Type	15 Cm Open From Bottom		
No. of holes	2		
Size (Cm)	15X20X40		
Materials	nlb	lb	mk
Thickness	4	4	4
Weight (Kg)	17.95	18.15	17

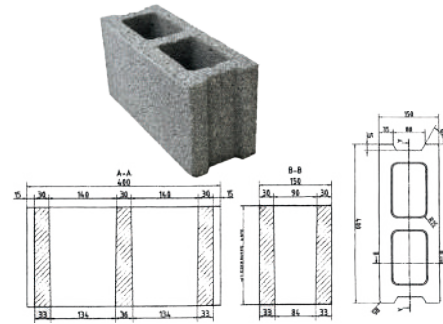

Product catalogue

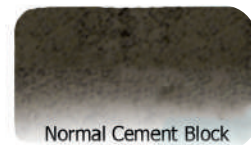
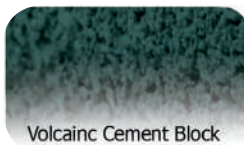

This is offset printout, colours may differ from the original stones, please see the original sample stone for colour variation.

Block (Open & close Bottom) 15 Cm

Technical details

Type	15 Cm (Opened & Closed) Bottom Block					
No. of holes	3					
Size (Cm)	15X20X40					
Materials	nib (open)	lb (open)	nib (close)	lb (closed)	ff (closed)	nib (closed - volcanic)
Thickness	3	3	3	3	3	3
Weight (Kg)	15.85	16.22	16.67	17.7	15.45	12.47

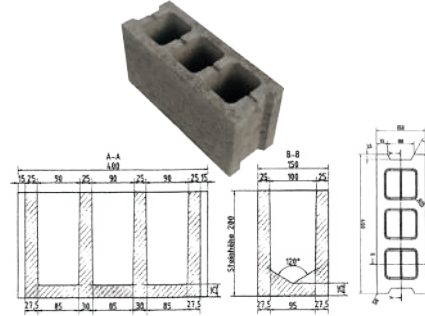

Product catalogue

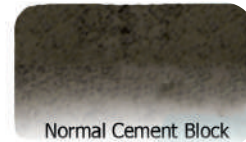

This is offset printout, colours may differ from the original stones, please see the original sample stone for colour variation.

Block (Solid) 15 Cm

Technical details

Type	15 Cm Solid Block
No. of holes	0
Size (Cm)	15X20X40
Thickness	-
Weight (Kg)	25.5

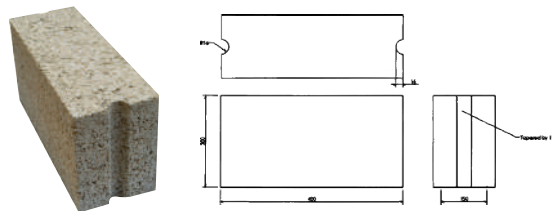

Product catalogue

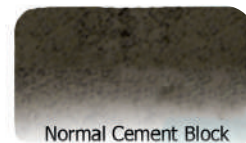
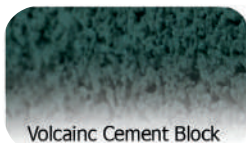

This is offset printout, colours may differ from the original stones, please see the original sample stone for colour variation.

Block (Open Bottom) 20 Cm

Technical details

Type	20 Cm Open From Bottom		
No. of holes	2		
Size (Cm)	20X20X40		
Materials	nib	lb	grov
Thickness	4	4	3
Weight (Kg)	19.47	21.92	16.87

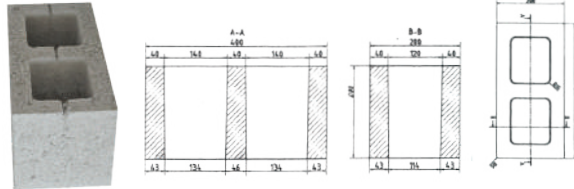

Product catalogue

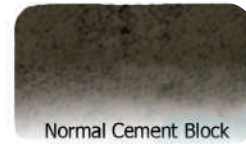

This is offset printout, colours may differ from the original stones, please see the original sample stone for colour variation.

Block (Open & close Bottom) 20 Cm

Technical details

Type	20 Cm (Opened & Closed) From Bottom								
No. of holes	3								
Size (Cm)	20X20X40								
Materials	nib	lb	ff	nib (volcanic)	lb	lb (open)	nib (open)	volcanic	mk(open)
Thickness	3	3	3	3	4	3	3	2	3
Weight (Kg)	20.92	21.4	19.85	14.2	14	19.42	19.37	12.45	17.6

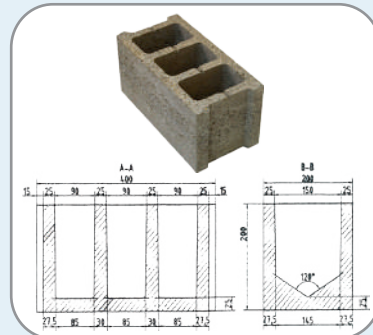

Product catalogue

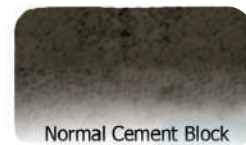
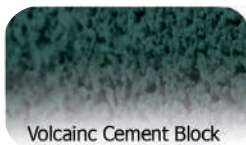

This is offset printout, colours may differ from the original stones, please see the original sample stone for colour variation.

Block (Solid) 20 Cm

Technical details

Type	20 Cm Solid Block	
No. of holes	0	
Size (Cm)	20X20X40	
Material	Normal	ff
Weight (Kg)	34.12	31

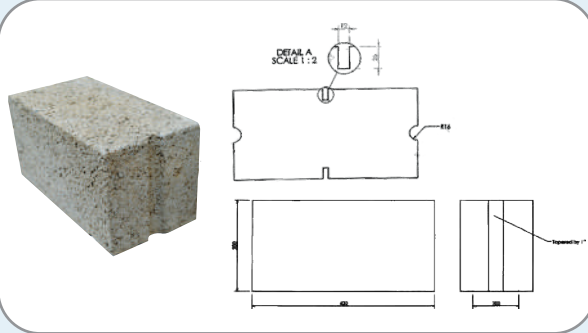

Product catalogue

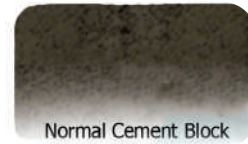

This is offset printout, colours may differ from the original stones, please see the original sample stone for colour variation.

Block (Insulated Full Auto) 20 Cm

Technical details

Type	20 Cm Closed From Bottom			
No. of holes	2 (Insulated Full Automatic)			
Size (Cm)	20X20X40			
Materials	Normal	Jaffali	Volcainc	Jaffali Volcainc
Thickness	7.5	7.5	7.5	7.5
Weight (Kg)	19	18.52	13.2	13.57

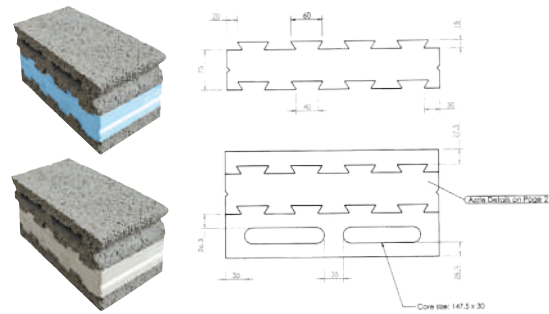

Product catalogue

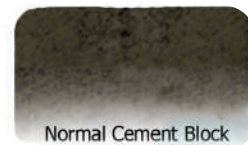

This is offset printout, colours may differ from the original stones, please see the original sample stone for colour variation.

Block (Insulated) 20 Cm

Technical details

Type	20 Cm Closed From Bottom			
No. of holes	2 (Insulated)			
Size (Cm)	20X20X40			
Materials	Volcanic	nlb	ff	lb (open)
Thickness	-	-	-	-
Weight (Kg)	14.57	21.15	20.12	20.62

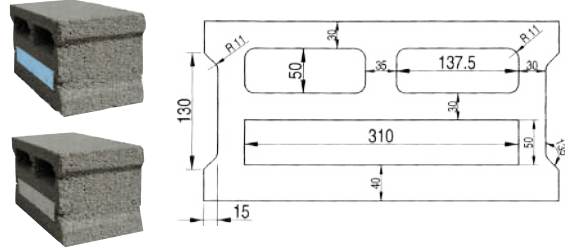

Product catalogue

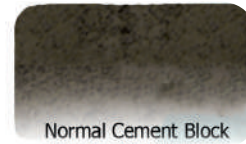

This is offset printout, colours may differ from the original stones, please see the original sample stone for colour variation.

Block (Closed Bottom) 25 Cm

Technical details

Type	25 Cm Closed From Bottom	
No. of holes	3	
Size (Cm)	25X20X40	
Materials	lb	nlb
Thickness	3	3
Weight (Kg)	24.25	22.14

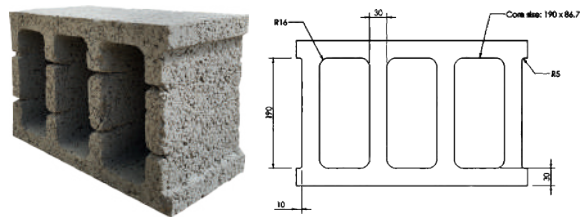

Product catalogue

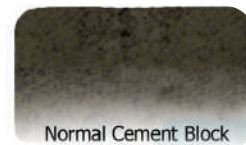

This is offset printout, colours may differ from the original stones, please see the original sample stone for colour variation.

Block (Open & Close Bottom) 25 Cm

Technical details

Type	25 Cm (Opened & Closed) From Bottom				
No. of holes	4 (Insulated)				
Size (Cm)	25X20X40				
Materials	nib (open)	lb (open)	lb (closed)	lb (closed-wo)	closed jaffali
Weight (Kg)	25.77	26.4	25.97	26.85	27.67

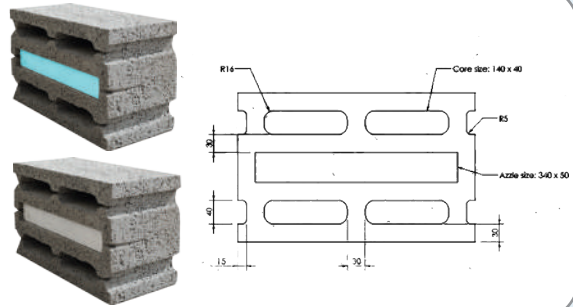

Product catalogue

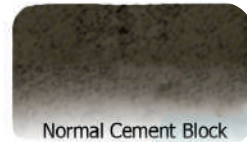

This is offset printout, colours may differ from the original stones, please see the original sample stone for colour variation.

Block (Solid) 25 Cm

Technical details

Type	25 Cm Solid Block	
No. of holes	0	
Size (Cm)	25X20X40	
Materials	ff	ff / wo
Weight (Kg)	26.05	25.5

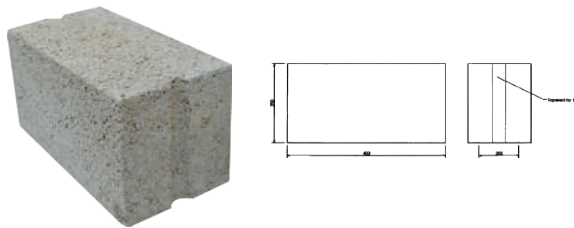

Product catalogue

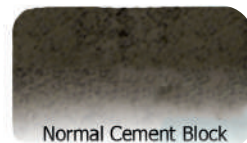

This is offset printout, colours may differ from the original stones, please see the original sample stone for colour variation.

Block (Closed Bottom) 30 Cm

Technical details

Type	30 Cm Closed Bottom Block		
No. of holes	3		
Size (Cm)	30X20X40		
Materials	volcanic	nlb	lb
Thickness	3	3	3
Weight (Kg)	20.3	27.65	28

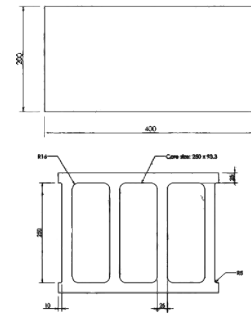

Product catalogue

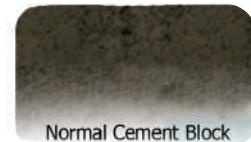

This is offset printout, colours may differ from the original stones, please see the original sample stone for colour variation.

Block (Insulated) 30 Cm

Technical details

Type	30 Cm Block				
No. of holes	4 (Insulated)				
Size (Cm)	30X20X40				
Materials	Volcanic	lb-wo	lb	ff-wo	ff
Thickness	-	-	-	-	-
Weight (Kg)	20.85	29.25	29.3	27.5	27.25

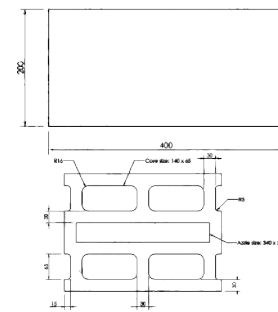
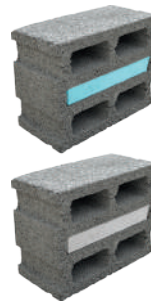

Product catalogue

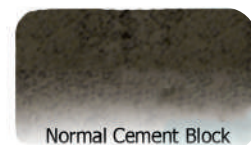
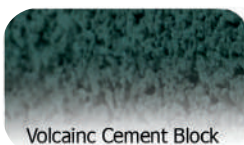

This is offset printout, colours may differ from the original stones, please see the original sample stone for colour variation.

Block (Insulated Full Auto) 30 Cm

Technical details

Type	30 Cm Insulated (Full Auto)	
No. of holes	2 (Full Automatic)	
Size (Cm)	30X20X40	
Materials	volcanic	nlb
Thickness	7.5 Cm & 5 Cm	
Weight (Kg)	20.3	28.47

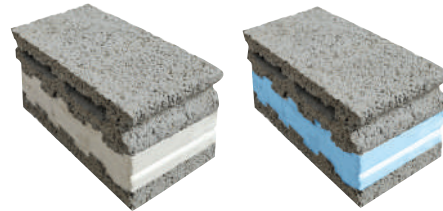

Product catalogue

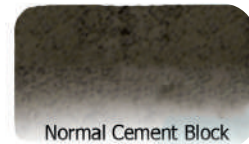

This is offset printout, colours may differ from the original stones, please see the original sample stone for colour variation.

Block Hordy

Technical details

Type	Opened & Closed From Bottom Hordy		
No. of holes	2 (Hordy)		
Size (Cm)	20X20X40	25X20X40	30X20X40
Thickness	3	3	3
Weight (Kg)	15.45	17.4	18.6

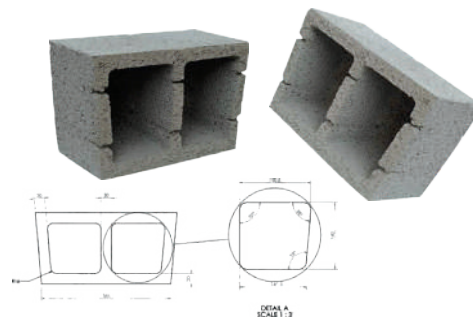

Product catalogue

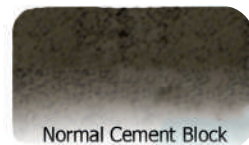
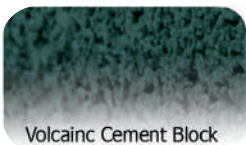

This is offset printout, colours may differ from the original stones, please see the original sample stone for colour variation.

Block (Extensions) 30 Cm

Technical details

Type	Closed From Bottom
No. of holes	8 Holes (Extension)
Size (Cm)	20X20X40
Weight (Kg)	22.65

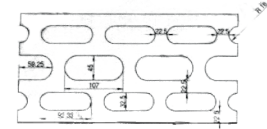

Product catalogue

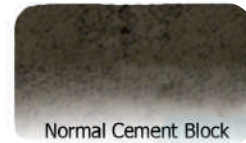

This is offset printout, colours may differ from the original stones, please see the original sample stone for colour variation.

Parking Kerbstone (Wheel Stopper)

Technical details

Type	Parking Kerbstone (Wheel Stopper)			
Size (Cm)	100X20X15	150X20X15	180X20X15	260X30X25
Stones Per LM	1	0.66	0.55	0.38
Weight (Kg)	57.55	58.3	80	420

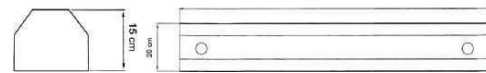
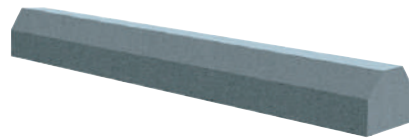

Product catalogue

Colours available

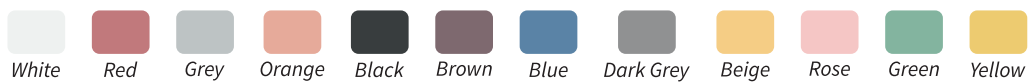

This is offset printout, colours may differ from the original stones, please see the original sample stone for colour variation.

Safety Barriers (New Jersey)

Technical details

Type	New Jersey 100X70X105	New Jersey 100X40X85	New Jersey 120X50X100	New Jersey 150X60X100
Weight (Kg)	940	420	880	1180

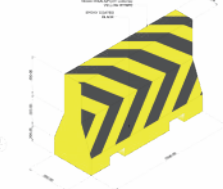
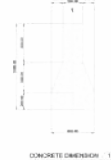
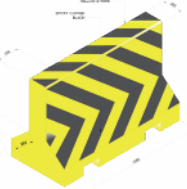
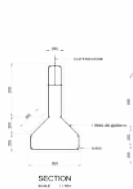

Product catalogue

Colours available

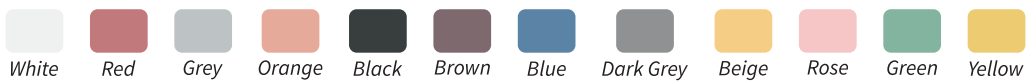

This is offset printout, colours may differ from the original stones, please see the original sample stone for colour variation.

Wall Barriers (New Jersey)

Technical details

Type	Wall Barriers
Size (Cm)	180X138X304
Weight (Kg)	2800

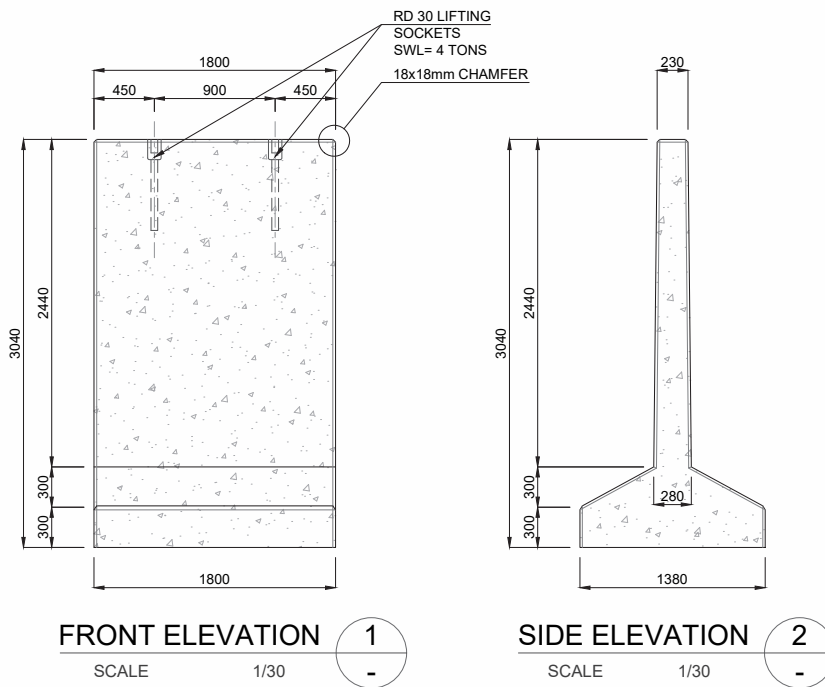
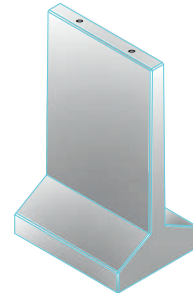

Product catalogue

Colours available

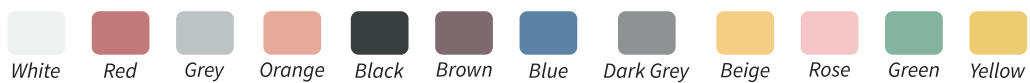

This is offset printout, colours may differ from the original stones, please see the original sample stone for colour variation.



يبدأ بيد

لبناء الوطن بأعلى جودة



مصنع سليمان عبدالرحمن النملة

لإنتاج البلوك و الإنترلوك و البردورات و البلاط

المختبر The Laboratory

قام مصنع سليمان عبد الرحمن النملة بتأسيس نظام لضبط الجودة تمكنه من تحقيق درجة عالية من الجودة لضمان مطابقة المواصفات الفنية للمنتجات، وللوصول إلى هذه الأهداف فإن المصنع يمتلك قسم ضبط الجودة يضم أفضل الخبرات الهندسية، بالإضافة إلى مختبر مجهز بأحدث أجهزة الاختبارات للقيام بالفحوصات الدورية اللازمة بما يتلائم مع متطلبات ومعايير الانظمة العالمية.



Sulaiman AbdulRahman Al Namlah factory has established a quality control system that enables it to achieve a high degree of quality to ensure matching the technical specifications of the products, and to reach these goals the factory has a quality control department that includes the best engineering expertise, in addition to a laboratory equipped with the latest testing equipment to carry out the necessary periodic checks including Compatible with the requirements and standards of global systems.





عملائنا Our Clients

01. Royal Commission For Jubail And Yanbu.
02. Aramco Company.
03. Sabic Company.
04. Nesma Company.
05. Holy Makkah Municipality.
06. Madinah Municipality.
07. Jeddah Municipality.
08. Samref Company.
09. Ministry Of Defense.
10. Ministry Of Housing.
11. Ministry Of Municipal And Rural Affairs.
12. The Red Sea Development Company.
13. Almajal Alarabi Group.
14. Amaala.
15. Neom.
16. Al Harbi Trading & Contracting Co. Ltd.
17. Tiba Contracting & Maintenance Co. Ltd.
18. United Branches Contracting Company Limited.
19. Peninsula Contracting Company.
20. Effat University.
21. Saudi Binladin Group.
22. East Gulf General Contracting.
23. Al Arrab Contracting Company.
24. Saudi Services For Electro Mechanic Works (Ssem).
25. Arab Fal General Contracting Est.
26. Branch Of Jiangsu Hanjian Group Limited.
27. Fanar Co., Ltd.
28. Petro Rabigh Company.
29. Branch Of China Jiwangnereng.
30. General Authority Of Civil And Aviation.
31. Rezayat Company Ltd.
32. Ministry Of Health.
33. Jack Contracting Company.
34. Yanbu Industrial Port.
35. Yanbu Commercial Port.
36. Rawasi Al Maden Contracting Co.
37. Roshn Real Estate Company.
38. Ba Hamdeen Trading & Contracting.
39. Msarat Tebah Contracting Co. Ltd.
40. Arabian Buildings Co.
41. Enjaz Co.
42. China Harbour Company.
43. China Railway Company.
44. Cities Contracting Coordinating Company - Citiscapex.
45. Washi Company And Bushnaq Contracting.
01. الهيئة الملكية للجبيل وينبع.
02. شركة الزيت السعودية - ارامكو.
03. سابك.
04. شركة نسما.
05. امانه العاصمة المقدسه.
06. امانه المدينه النوره.
07. امانه محافظه جدّه.
08. سامرف.
09. وزاره الدفاع.
10. وزاره الاسكان.
11. وزاره الشؤون البلديه والقريه.
12. شركه البحر الأحمر للتطوير.
13. شركه مجموعة المجال العربي.
14. أمال.
15. مشروع نيوم.
16. شركة الحربي للتجارة و المقاولات المحدودة.
17. شركة طيبة للمقاولات و الصيانة المحدودة.
18. شركة فروع المتحدة للمقاولات المحدودة.
19. شركه شبه الجزيره للمقاولات.
20. جامعه عفت.
21. مجموعه بن لادن السعودية.
22. الشركة الشرقية الخليجية للمقاولات العامة.
23. شركه العراب.
24. الشركة السعودية لخدمات الأعمال الكهربائية و الميكانيكية.
25. مؤسسة الفال العربية للمقاولات العامة.
26. فرع شركة جيانغسو هانجيان جروب ليمتد.
27. شركة الفنار المحدودة.
28. بترو رابغ.
29. فرع شركة شاينا جيوانجنيونج.
30. الهيئة العامة للطيران المدني.
31. شركة رضايات المحدودة.
32. وزاره الصحه.
33. شركة جاك للمقاولات.
34. ميناء ينبع الصناعي.
35. ميناء ينبع التجاري.
36. شركة رواسي المدن للمقاولات.
37. شركه روشن العقارية.
38. شركة با حمدين للتجارة و المقاولات.
39. شركه مسارات طيبه.
40. شركه المباني.
41. شركه الانجاز.
42. شركه شاينا هاربر.
43. شركه شايناريلوي.
44. شركة تنسيق المدن للمقاولات.
45. شركة اشى و بشناق للمقاولات.

مشاريعنا Our Projects

02

أرض الجوار

وزارة الاسكان - شركة عبر المملكة
المدينة المنورة

04

أعالي جدة

وزارة الاسكان - شركة أبياتنا العقارية
جدة

06

فندق اكوارافلز

الراجحي - شركة العراب
جدة

08

فندق موفينبيك

شركة الهاشمية
جدة

10

الطائف بارك

شركة السمان
الطائف

01

توسعة الحرم المكي

وزارة المالية - مجموعة بن لادن السعودية
مكة المكرمة

03

مستشفى الملك فيصل التخصصي

مجموعة بن لادن السعودية
جدة

05

الجوهرة ريزيدنس

وزارة الاسكان - شركة المزيبي - شركة بلت
جدة

07

فندق الماريوت

شركة السعد
جدة

09

الزاهد

شركة الزاهد للتراكتورات - شركة السعد - شركة
صماري - شركة الشرق ويفرز
جدة

مشاريعنا Our Projects

12

بلاط وارصفة

أمانة العاصمة المقدسة - شركة العيوني
مكة المكرمة

11

بلاط وارصفة

أمانة جدة - شركة منارات المتكاملة
جدة

14

ممشى الهجرة

أمانة المدينة المنورة - شركة فيصل علوي
شركة القلغمي - المدينة المنورة

13

بلاط وارصفة

أمانة المدينة المنورة شركة فيصل علوي
شركة مسارات طيبة - المدينة المنورة

16

أملا

شركة التميمي
ضبا

15

العشار

شركة نسما وشركائهم
العلا

18

محطات نخلية

شركة تزامن روافد وتقنية المياه
ضبا - الوجه - أملج

17

البحر الأحمر

شركة المجال العربي
أملج

20

مباني دراسية

جامعة طيبة - شركة البلاد الوطنية
المدينة المنورة

19

ممشى الدعيثه

أمانة المدينة المنورة - شركة فيصل علوي
المدينة المنورة

21

نيوم

شركة نسما وشركائهم

Our Companies شركات شقيقة



**Suleiman A. R. Namlah Corp.
For Contracting**

**مؤسسة سليمان عبد الرحمن
النملة للمقاولات**

It is one of the leading institutions in the field of infrastructure in the Kingdom of Saudi Arabia, founded in 1989 AD, and its main office is located in the Royal Commission in Yanbu, the company obtained an ISO certificate as the number of its employees exceeds 700 employees and owns more than 150 equipment

هي احدى المؤسسات الرائدة في مجال البنية التحتية في المملكة العربية السعودية، تأسست في عام ١٩٨٩ ميلادي، ويقع مكتبها الرئيسي في الهيئة الملكية ينبع، حصلت الشركة على شهادة الأيزو حيث ان عدد موظفيها يزيد عن ٧٠٠ موظف وتمتلك أكثر من ١٥٠ معدة



Al Namlah Crushers

كسارات النملة

Al Namlah Group owns modern crushers to supply raw materials for projects and factories in Yanbu of various types and sizes according to specifications and high production capacity and has a fleet of trucks to transport the materials.

تمتلك مجموعة النملة كسارات حديثة لتجهيز المواد الأولية للمشاريع والمصانع في ينبع بمختلف الأنواع والمقاسات حسب المواصفات وبطاقة إنتاجية عالية ولديها اسطول من الشاحنات لنقل المواد.

Our Companies شركات شقيقة



SANCO Co. for equipments rent

شركة سانكو لتأجير المعدات

Sanco was established in 2007 in the industrial city of Yanbu. The leasing sector provides customer service in the civil, industrial and commercial contracting sector as the company provides a large number of employees and a fleet of equipment (cranes, gills, etc.) serving customers in various projects.

تأسست شركة سانكو في عام ٢٠٠٧ في مدينة ينبع الصناعية، قطاع التأجير يوفر خدمة العملاء في قطاع المقاولات المدنية والصناعية والتجارية حيث ان الشركة توفر عدد كبير من الموظفين واسطول من المعدات من (كربونات ، جريدرات ... إلخ) يخدم العملاء في شتى المشاريع .



SANCO Roads Paint and Safety

سانكو لدهانات الطرق وأعمال السلامة

Sanco Paint and Safety Works Working in the field of road safety works, implementation of road paints and installation of signs

And the panels, guidance and all works related to road safety and maintenance, have won the trust of all since the beginning of its activity, due to the mechanisms and equipment it possesses and developed.

سانكو لدهانات الطرق وأعمال السلامة تعمل في مجال أعمال سلامة الطرق و تنفيذ دهانات الطرق و تركيب العلامات و اللوحات والإرشادية وجميع الأعمال الخاصة بسلامة الطرق وصيانتها، نالت منذ بداية نشاطها ثقة الجميع وذلك نسبة لما تمتلكها من آليات ومعدات ومتطورة.

MASA

Milestone To Your Success





SANCO



SANCO



Milestone To Your Success



SANCO





إنتاج البلوك و الإنترلوك و البردورات و البلاط

Suliman A.R Namlah Factory Block - Interlock - Krbstone Tiles

Tel: 0143213755 - 0143571112 / Fax: 0143211587

Yanbu Al Sinaiyah - C6 - P.o.box: 32322

Postal Code: 41912